

HD 280 PRO

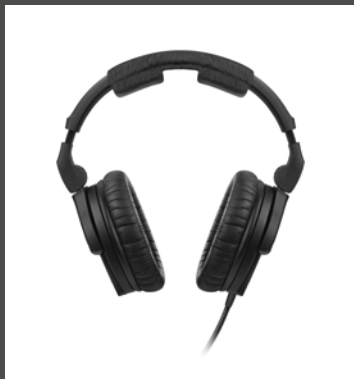

In the box



Adjusting

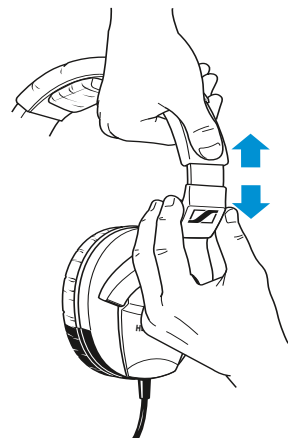

Folding up the headphones

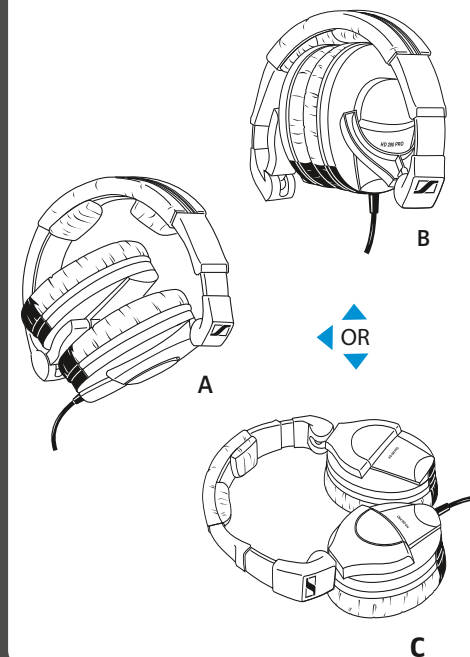

Quick Guide
Kurzanleitung
Guide rapide
Guida rapida

Instrucciones resumidas
Beknopte handleiding
Краткая инструкция
快速指南

Replacing spare parts

Headband padding

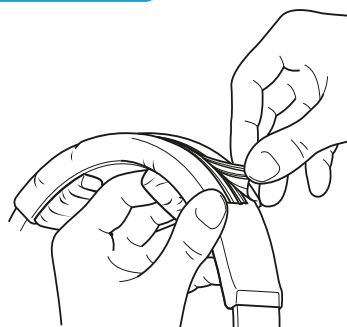

Ear cushions

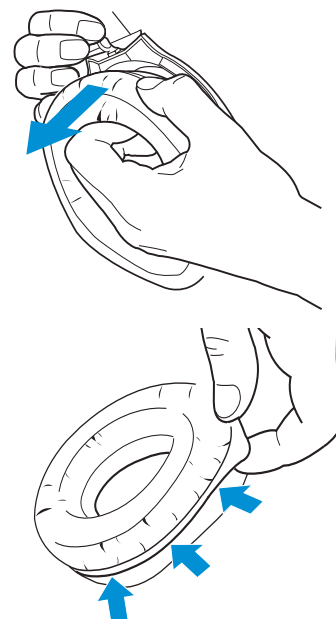

Specifications

Headphone HD 280 PRO

| | |
|---------------------------|-----------------------------|
| Acoustic principle | dynamic, closed |
| Impedance | 64 Ω |
| Ear coupling | circumaural |
| Frequency response | 8 - 25,000 Hz |
| Ambient noise attenuation | ≤ 32 dB |
| THD | <0.1% (@ 1 kHz, 100 dB SPL) |
| Weight (w/o cable) | approx. 285 g |
| Contact pressure | approx. 6 N |
| Length of coiled cable | ≥ 1.3 m / ≤ 3 m |
| Operating temperature | -10 °C to +55 °C |
| Storage temperature | -20 °C to +70 °C |
| Relative humidity | $\leq 90\%$ @ 40 °C |

Sennheiser electronic GmbH & Co. KG

Am Labor 1, 30900 Wedemark, Germany
www.sennheiser.com

04/16, 566630/A02