

*Clavinova*®

**How-to:**

**CLP-700**

**Smart Pianist Wireless Operation**

**Bluetooth connection**

**CLP-735/745/775/785/765GP/795GP**

Download the Yamaha Smart Pianist App from App Store / Google Play  
(The same App as previously).



Go to SETTINGS – select the Smart Pianist app. Allow Smart Pianist access to Bluetooth

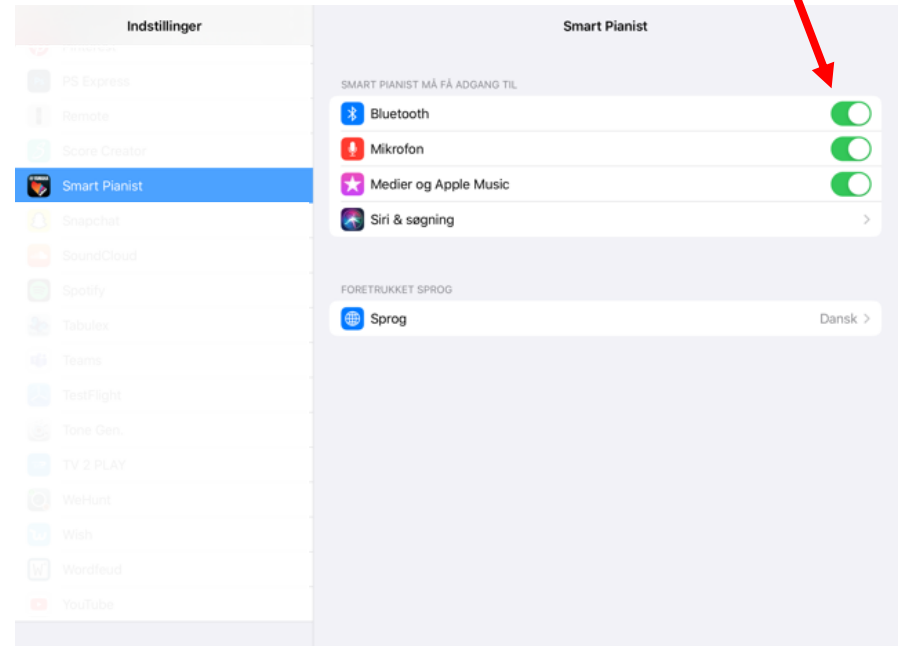
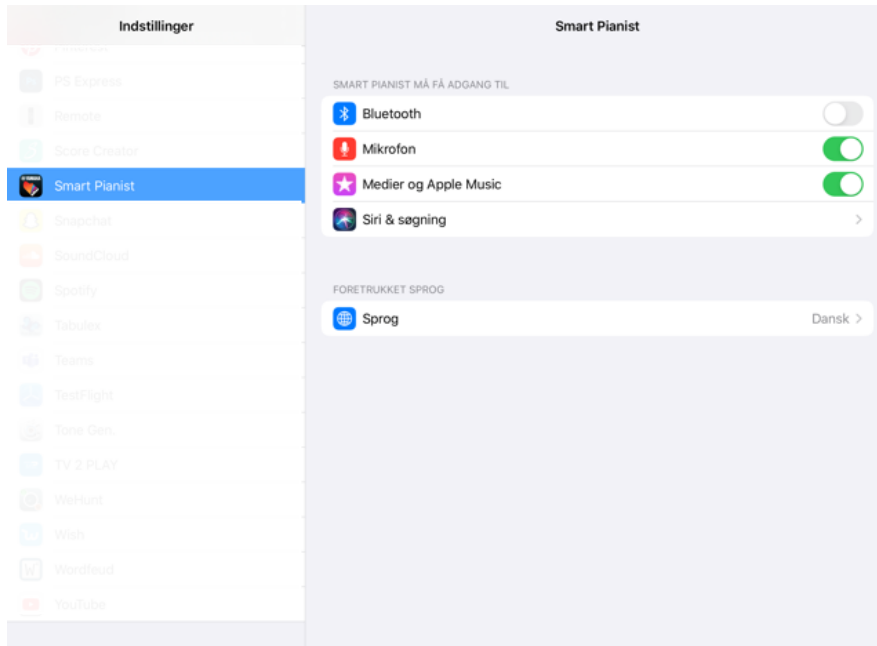

Open the App and press  and Instrument

1

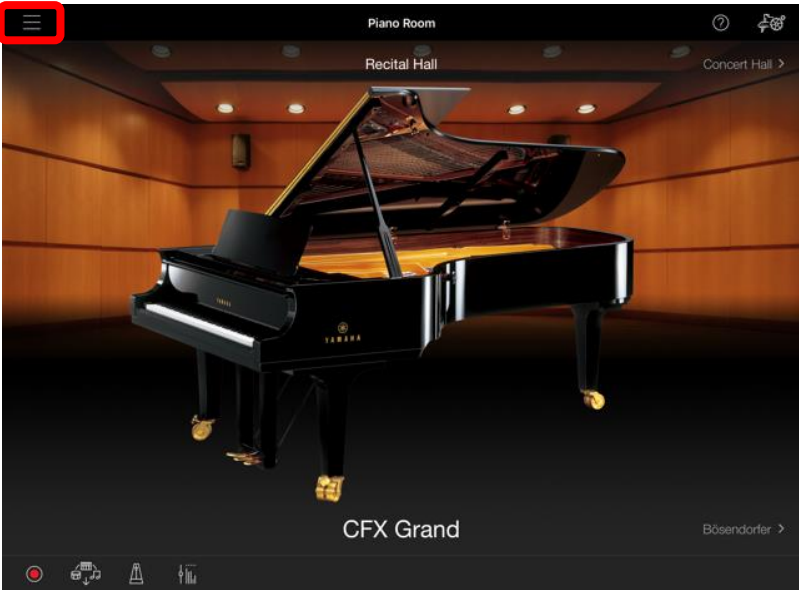

2

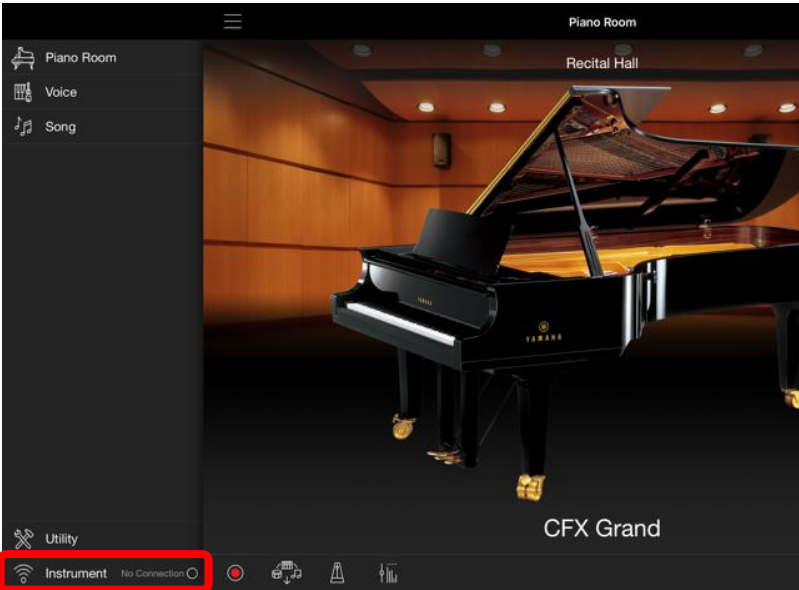

Start connection wizard and select Bluetooth

3

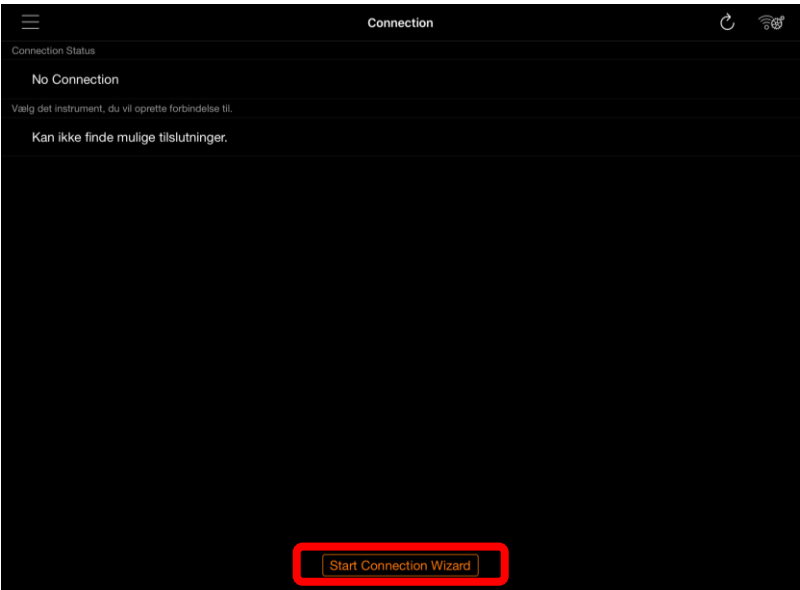

4

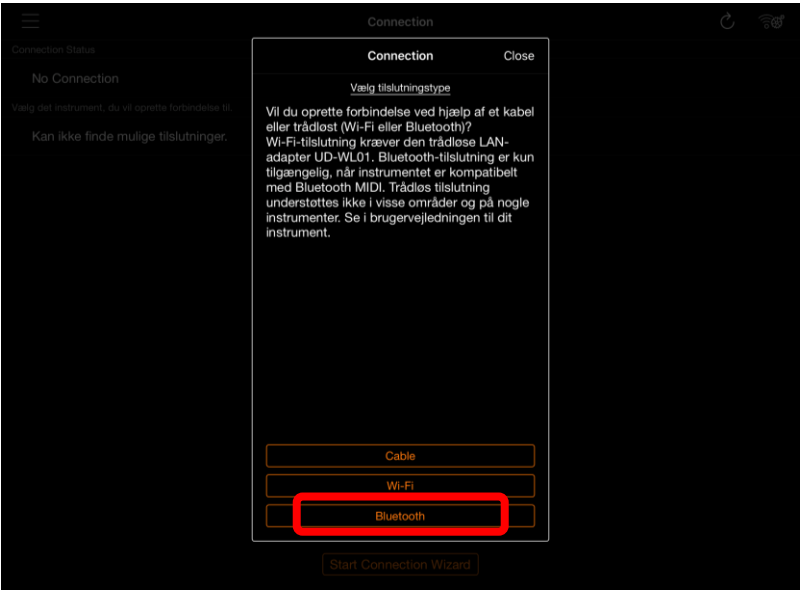

Press YES. Switch ON Power on the CLP. Wait 10 seconds and press NEXT

Press Connect Bluetooth Midi Device and press the CLP-7XX

5

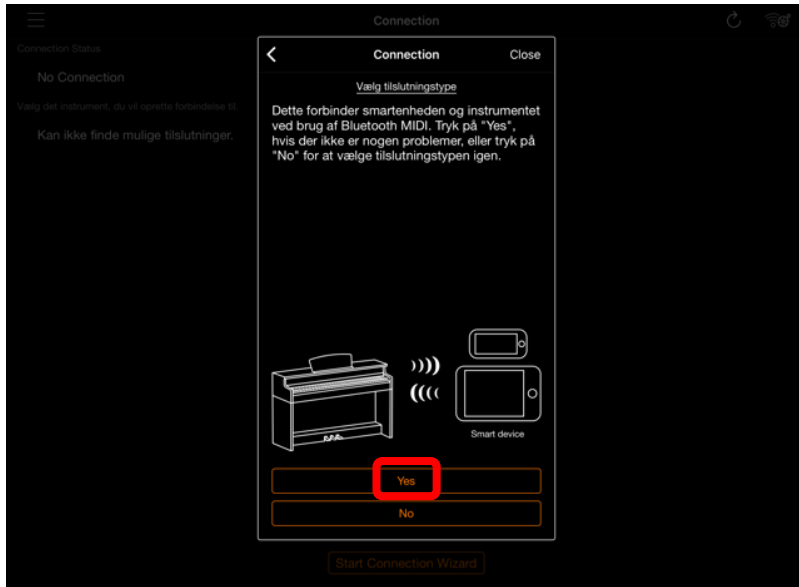

7

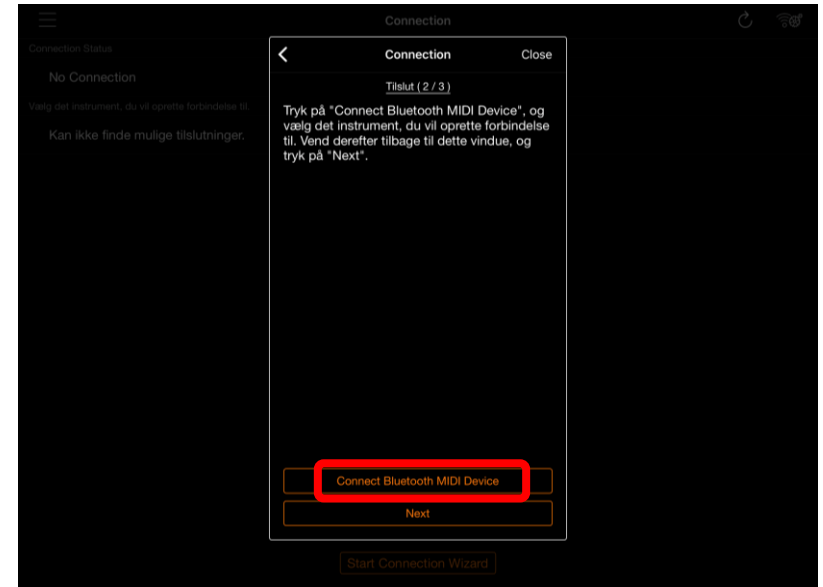

6

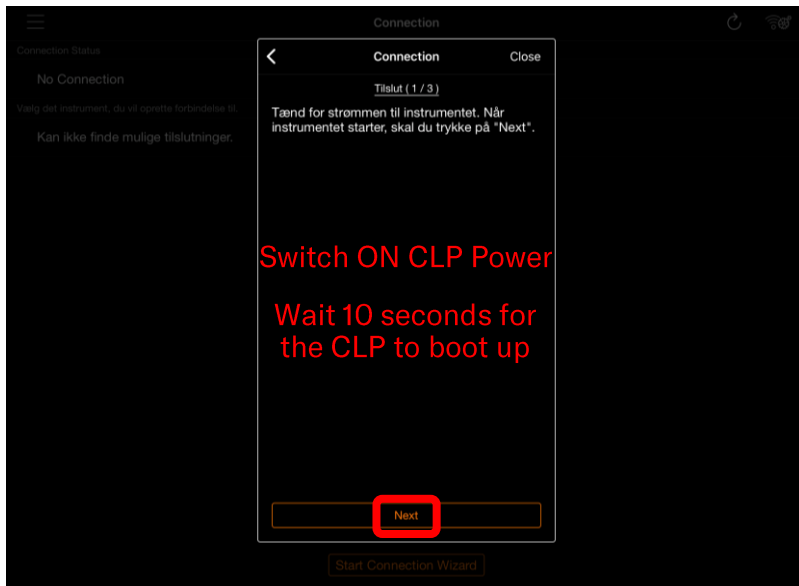

8

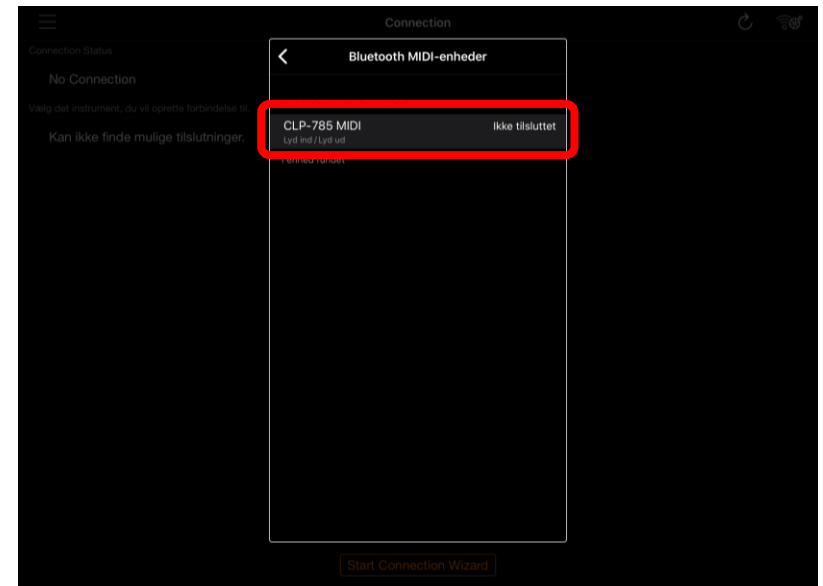

9 : Connecting...

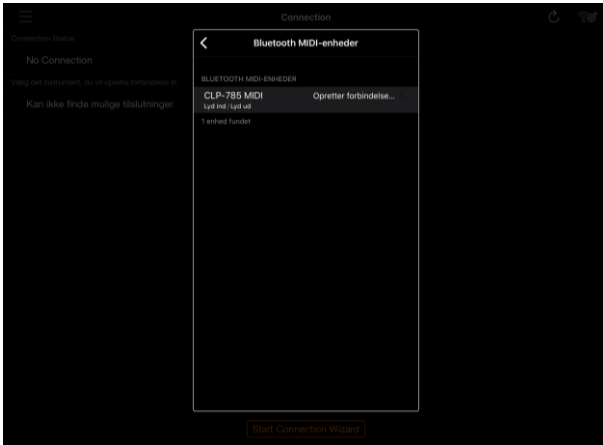

10 : Connected ! Go back

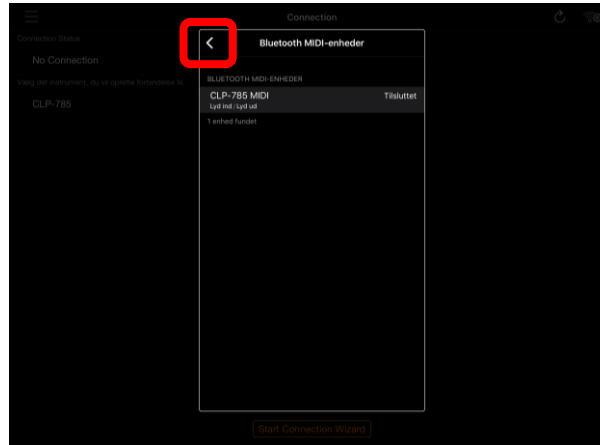

11 : Press NEXT ...

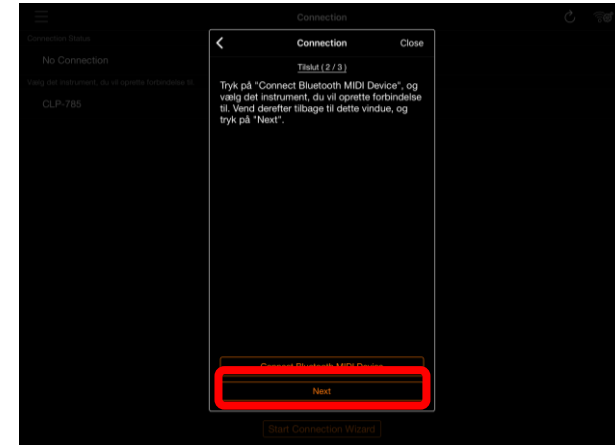

12 : Press CLP-7XX

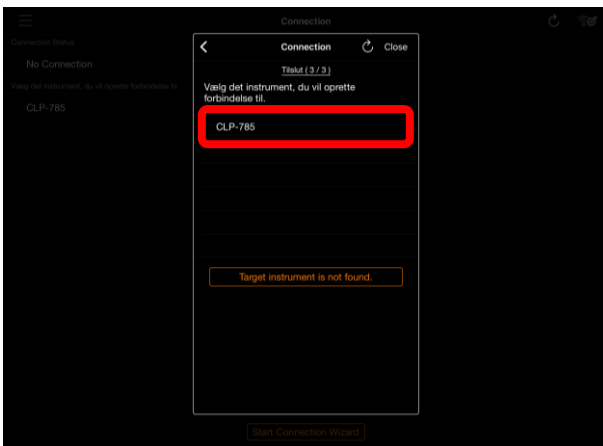

13 : Connecting...

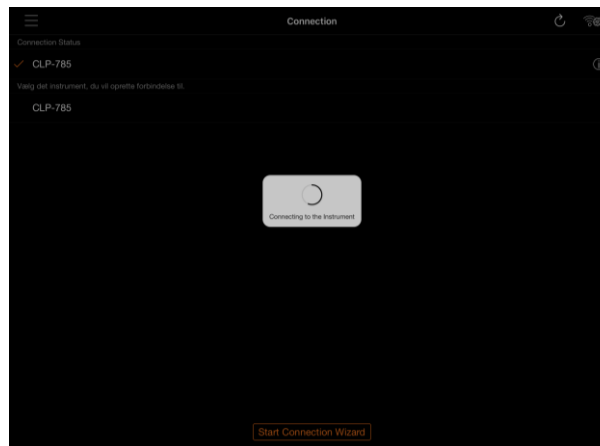

14 : Done ✓  
Press  and Piano Room.

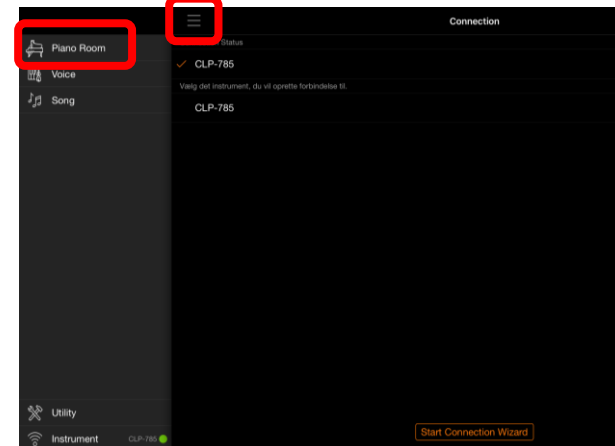

Ready to play.... You need to do this once, per iPad/iPhone / Device (Pairing).